



Lever scroll chuck is specially designed for grinding twist drills and other cutting tools.

Standard accessories:

- 1 operating lever
- 1 set of mounting screws
- 1 set of hard solid jaws



K01 SERIES THREE-JAW LEVER SCROLL CHUCKS

Dimensions

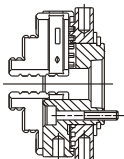
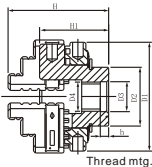

Clamping range

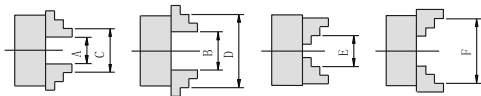

SPECIFICATIONS

UNIT:mm

Chuck Size	Code No	D1	D2	D3	D4	h	H	H1
50	K01-50	50	28	15	M12K M14K SM3/4" ×16	4	48	33
65	K01-65	68	28	15	M12K M14K SM3/4" ×16	4	48	33
80	K01-80	84	45	25	3-M5	3	42	30

SPEC./MODEL	Max. Gripping Dia.			Max. Speed (r.p.m)	Max. Gripping Force (kN)	Gross Weight (Kg)
	Internal Jaws		External Jaws			
	A-B	C-D	E-F			
K01-50	1-15	20-48	20-47	9000	7	0.4
K01-65	2-16	25-60	22-55	8200	8	0.7
K01-80	2-18	25-75	22-63	7500	9	1.2